

ASSEMBLY INSTRUCTIONS - RECLINER

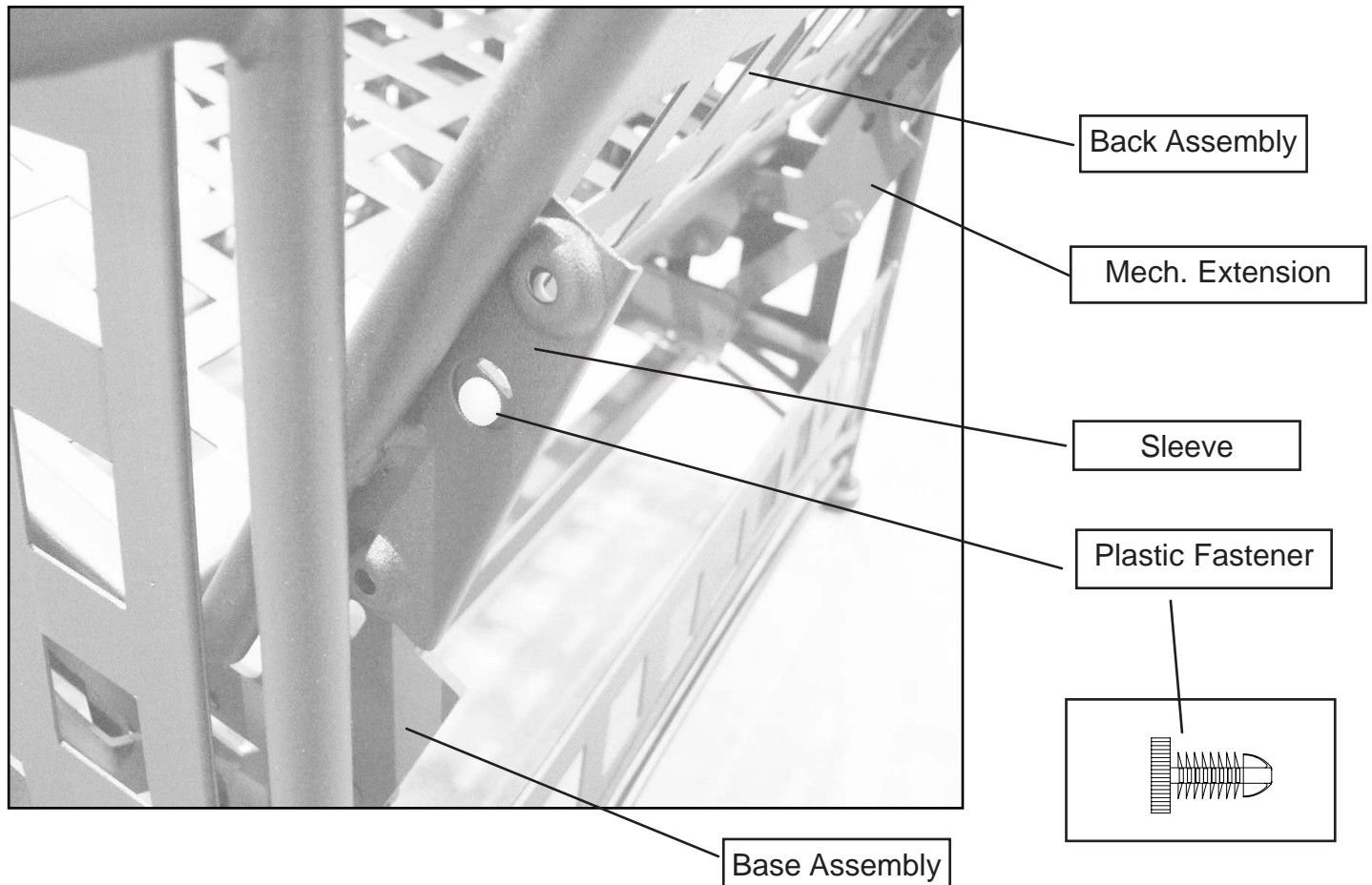

1. Mount the Back Assembly onto the Base Assembly by sliding the welded-on sleeves of the Back Assembly over the recliner mechanism extensions.
2. Align the center hole of each sleeve with holes in the mechanisms and install a plastic fastener through each. The fastener should be inserted through the sleeve first, then the mechanism.
3. Assembly is complete. Enjoy.

*** CAUTION: Do not attempt to pull the back assembly off once assembly is complete. When moving this furniture, remember to pick it up from the sides. Do not drag it by pulling on the back.

70002868

Rev. 03/29/05